

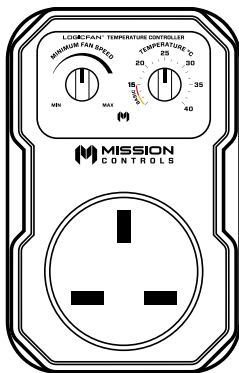

MISSION[®]
CONTROLS

READ = SUCCEED
IGNORE = FAILURE



LOGiCFAN[™]
TEMPERATURE CONTROLLER
6.5A

User Instructions

EN

RU

SQ

PL

LT

NL

FR

DE

IT

ES



LOGICFAN™

TEMPERATURE CONTROLLER

6.5A

Features:



Enviro-Sense™



Fluid-Motion™

- Controls 1 fan
- Dual mode
- Compact design
- Will not obstruct adjacent plug sockets
- Integrated Plug
- Fixed Temperature Sensor NTC 3m
- CE Certified
- 2 year warranty

Understanding Features - Visit www.missioncontrols.com

What's in the box:

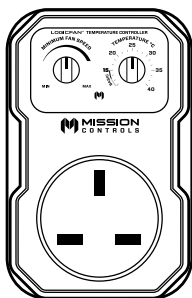

LogicFan™
Temperature Controller

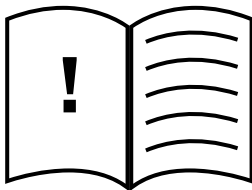

User Instructions

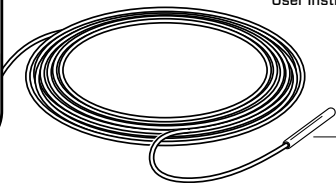

Temperature
Sensor
NTC 3m



**Need more
assistance?**

Scan the QR or visit
our website for help:

www.missioncontrols.com



Setting up:

- 1** Plug **LogicFan™** Temperature Controller into mains socket.

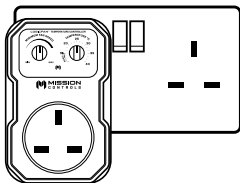

- 2** Plug fan into the socket of **LogicFan™** Temperature Controller.

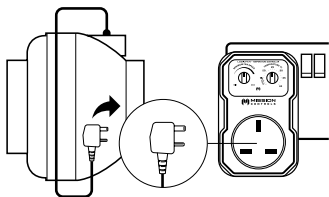

- 3** Position Temperature Sensor inside room, taking care to avoid places where it may take a false reading, such as directly under lights, or in front of fan.

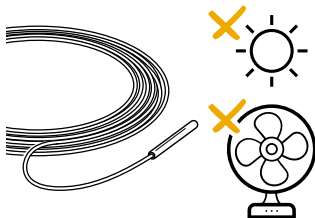

- 4** Switch on at mains.

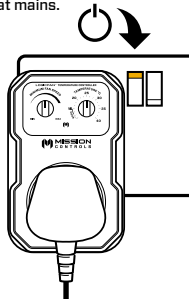

How to use:

BASIC mode:

1. Turn dial 2 to 'BASIC'.
2. Control fan speed with dial 1.

LOGIC mode:

1. Set minimum fan speed on dial 1. Fan will work between set minimum and full speed.
2. Turn dial 2 to target temperature.
3. Switch on at mains.
4. Controller will enter a short period of calibration. During this time, fan may pulse up and down. After approximately 5 minutes, fans will find the right speed.

BASIC mode:

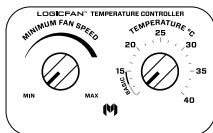

LOGIC mode:

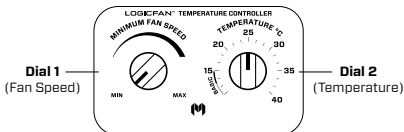



LOGiCFAN™

TEMPERATURE CONTROLLER

6.5A

Technical Specifications:

6.5A	220/240V	50Hz	1500W
------	----------	------	-------

Please visit www.missioncontrols.com and navigate to the product page to download the instruction manual in your preferred language.



www.missioncontrols.com/learn



MISSION®
CONTROLS

www.missioncontrols.com